

## Appendix 2 – Plans and Images

### Existing Site Location Plan

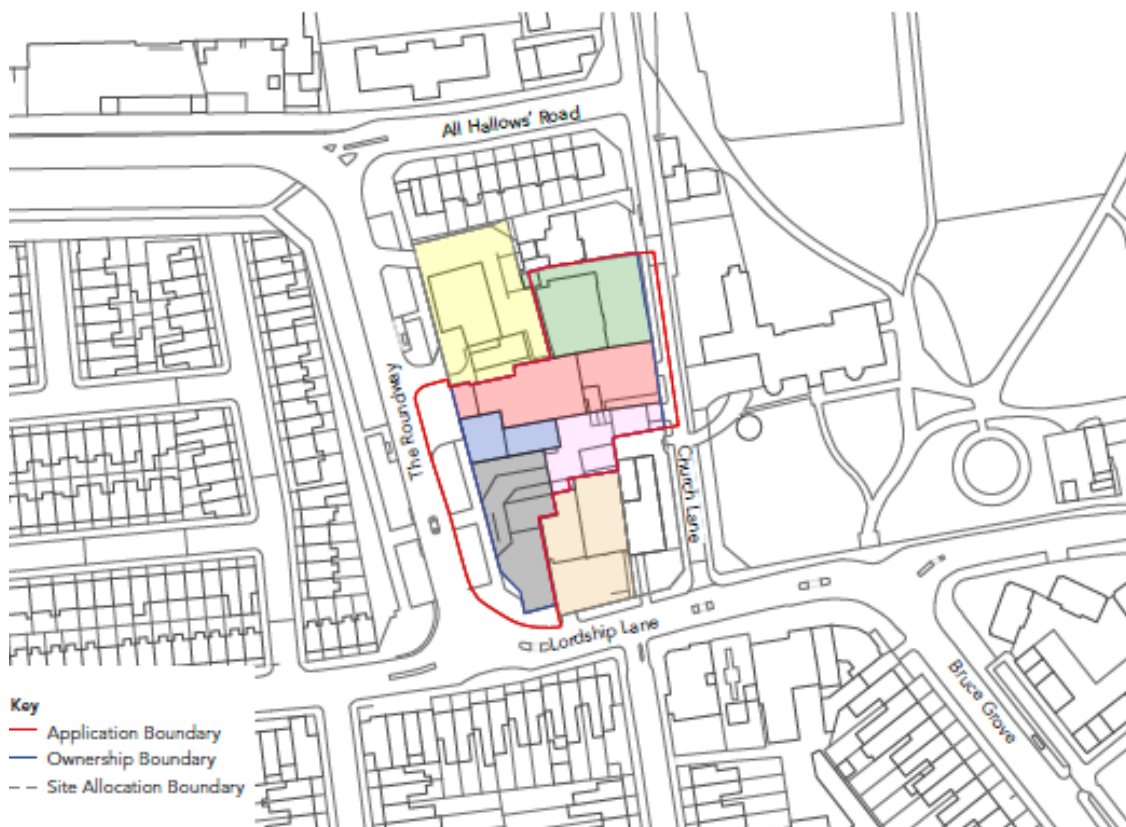

### Existing Site Ownership Plan



## Existing Heritage Layout Plan

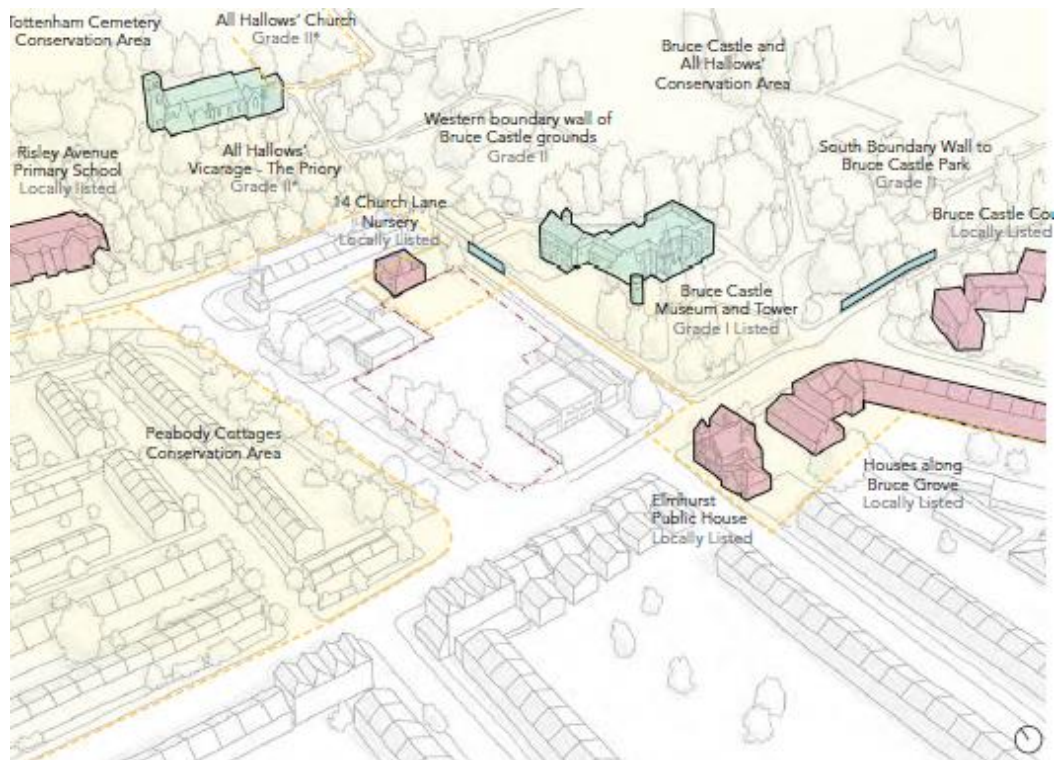

## Aerial Image of Proposed Development





Image from The Roundway



Close Up Image from The Roundway



Church Lane Image



Internal Courtyard Image



The Roundway/Lordship Lane Junction Image (Including Materials Description)



- Lightweight metal recessed top floor
- Brickwork taking reference from predominant building type in the local area
- Terracotta coloured precast coping
- Openings accented with contrasting sills referencing Peabody cottages
- Recessed brick on balcony upstands drawing influence from walls in the local area. Address Signage can be incorporated.



## Masterplan

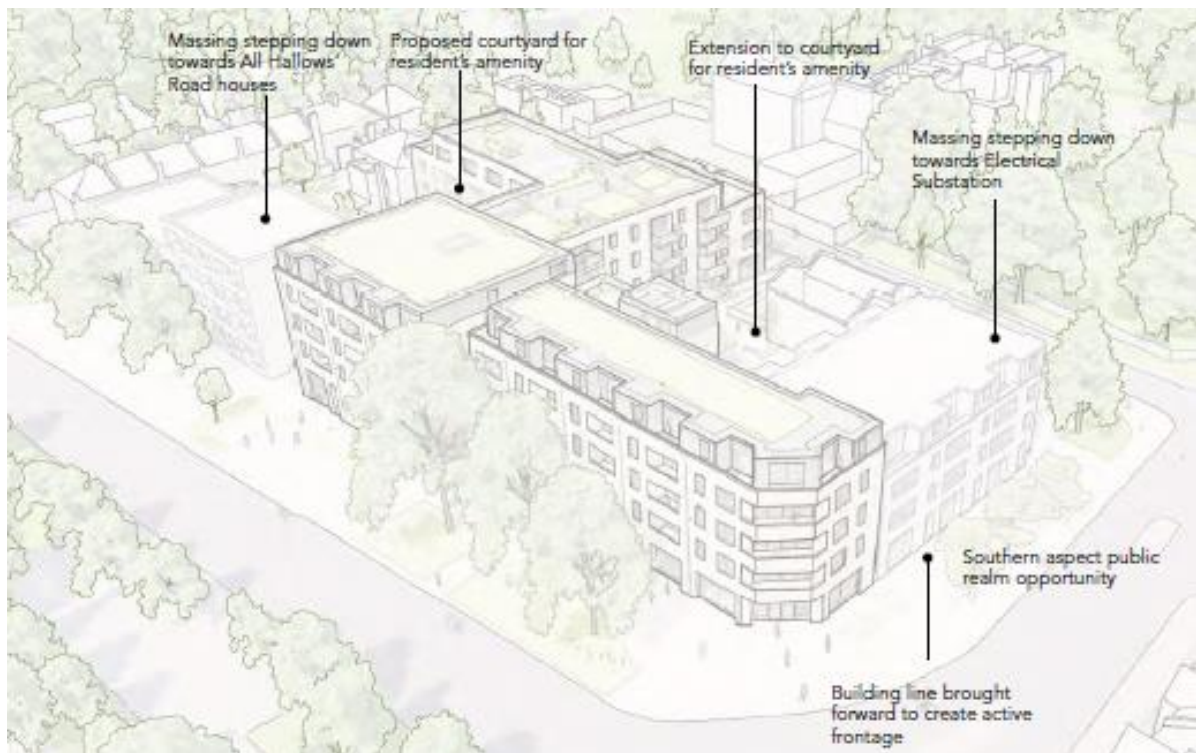

Image Showing Location of Affordable Housing Block (B)



Proposed Development in Local Views (nos. 1, 3 and 7 from submitted BHTVIA)





Proposed View from Lordship Lane (View no. 11 in BHTVIA)



Proposed View from Peabody Cottages (View no. 4 in BHTVIA)



## Proposed Landscaping Layout

